

Block Type Manifold

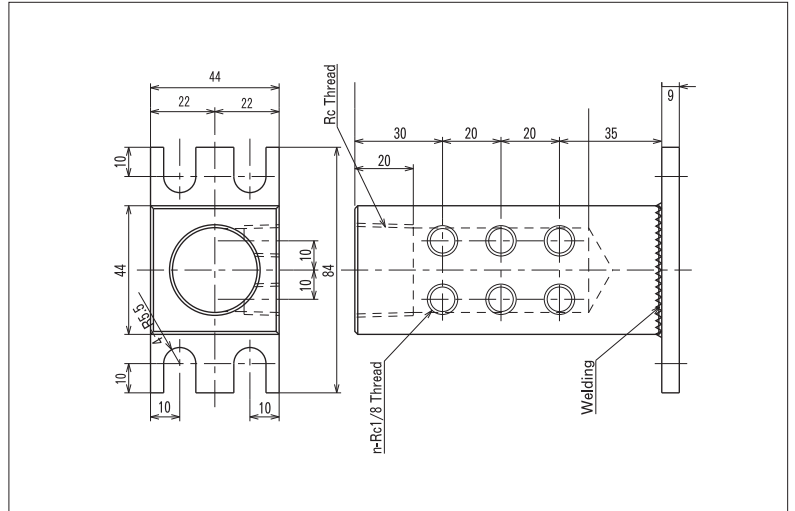

● Use

Cooling hoses are gathered on the block fixed on a die, to which a large diameter hose is "one-touch" connected.

● Characteristics

- This is suitable for small size die with small number of cooling channels.
- It can be connected "one-touch" to a die, even if the die has many cooling ports.
- The number of holes for hose connection is 10 or 20, or adjustable to any number suitable for the size of a die.

● Specification

Model	Specification	
BCM	Mounting Flange	M6 Pitch65
	Thread, Top Section	Rc1/8
	Thread, Root Section	Rc1
	Material	SS400(can be plated)
	Dimensions	Width
	Depth	
	High	

Change of specification, etc. is available. Please contact us.

● Example of order code designation

Model	Thread, Root Section	Thread, Top Section	Hole Number
BCM	1	1/8	20