

CT-HSRO

Cool Tube

(Stainless Steel, Revolving Head,O-ring Type)

Cool Tube (Stainless Head Revolving O-Ring Type)

CT-HSRO (Stainless Head Revolving O-Ring Type)

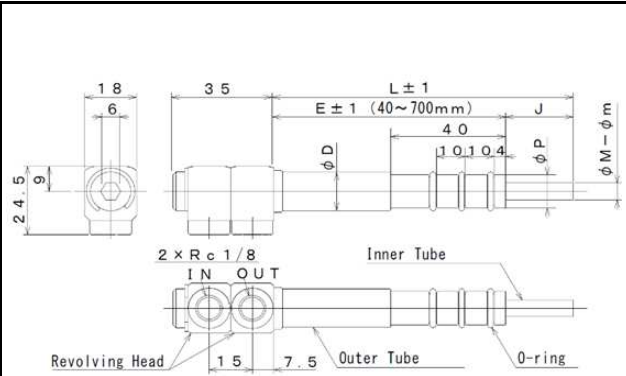
**● Use・Characteristics**

- The head part rotates separately, allowing the hose position in any requested direction.
- The head size became approx. 50% smaller comparing with CT-K type without decrease of cooling water volume.
- The corrosion resistance became higher by making outer tube and inner tube SUS.
- Pulling and inserting can be easily done thanks to O-ring.

● Material

Head : BS (Brass)

Outer Tube, Inner Tube : SUS304

O-ring (Die connecting part, Rotating part inside) : JIS4D (Heat Resintace 200℃)



● Maximum 0.5MPa**● Maximum Working Temperature 150℃****● Standard List**

(Unit : mm)

Model	Type	Nominal	Head			Outer Tube				Inner Tube		L
			L	H	W	Outer Dia.	Inner Dia.	O-ring Part	O-ring	Outer Dia.	Inner Dia.	
						ϕ D	ϕ d	ϕ P	JIS B2401	ϕ M	ϕ m	
CT	HSRO	1	35	25	18	10.5	5.7	10.0	P8	4.0	3.0	20~1000 (E: 20~700)
		2				13.8	7.8	12.0	P10	6.0	5.0	
		3				17.3	12.7	17.0	P14	8.0	7.0	

Inner Tube is thin type only

●Extra Processing

Extra Processing	Extra Processing Code	Example	Remark
$\phi 6$	P61・P61S		
$\phi 8$	P81・P81S		
Marking	MK□□□□□ Please designate letters and numbers		Max. letters : 5 (English or number)

※Please see our catalogue 2019 P81 for coupler and nipple information.

●Recommended Mounting Dimensions

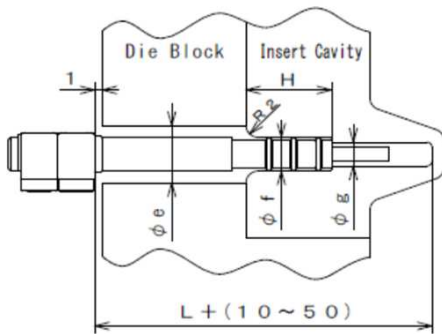

(Unit : mm)

Model	Type	Nominal	Die Block Hole Dia.	O-ring Part	Top Hole Dia.	O-ring Depth
			φe	φf	φg	H
CT	HSRO	1	15	11 +0.05 0	6~	30
		2	17	13 +0.05 0	8~	
		3	22	18 +0.06 0	12~	

※Ra3 or higher is recommended for the surface roughness of O-ring hole diameter.

■Cautions for use

- please do not use any fluid other than water and air.
- Please do not pull out Cool Tube and/or hose during use, there might be burn.
- Please connect cooling hose with Cool Tube correctly (There are IN and Out) , if you connect hoses wrongly, this will not work properly.
- Please be careful to not harm O-ring when pulling and putting it as O-ring breakage might cause water leakage.
- Please use soapy water or Netutral detergent when putting to die. Please do not use other things.
- Please use Cool Tube with prevention such as lean steeper as there might be water leakage when Cool Tube leans
- Please be careful to not exceed heat resistance of o-ring in any case otherwise o-ring will be broken.

■Cautions for die design

- Please use steeper board as prevention, o-ring type Cool Tube is easily taken off from die.
- Please use Cool Tube with edge flat as danger prevention. We do not supply inner tube with a sharp point.

●Example of Order Code Designation

Model	Type	Nominal	Length	Outer Length	Inner Protrusion
CT	HSRO	1	L200	E150	J50

●Example of Order Extra Processing

Model	Type	Nominal	Length L	Outer Length E	Inner Protrusion J	Tube Coupler	Marking (MK)
CT	HSRO	1	L200	E150	J50	P61	MK_A1234