

## Block Type Manifold

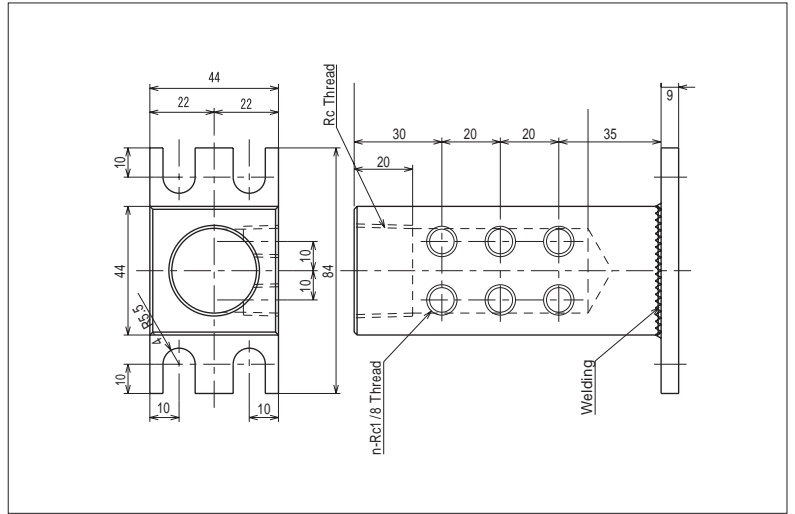

### ● Use

Cooling hoses are gathered on the block fixed on a die, to which a large diameter hose is "one-touch" connected.

### ● Characteristics

- This is suitable for small size die with small number of cooling channels.
- It can be connected "one-touch" to a die, even if the die has many cooling ports.
- The number of holes for hose connection is 10 or 20, or adjustable to any number suitable for the size of a die.

### ● Specification

Model	Specification				
BCM	Mounting Flange	M6 Pitch65			
	Thread, Top Section	Rc1/8			
	Thread, Root Section	Rc1			
	Material	SS400(can be plated)			
	Dimensions	<table border="1"> <tr> <td>Width</td> <td rowspan="3">Depend on the number of connections.</td> </tr> <tr> <td>Depth</td> </tr> <tr> <td>High</td> </tr> </table>	Width	Depend on the number of connections.	Depth
Width	Depend on the number of connections.				
Depth					
High					

Change of specification, etc. is available. Please contact us.

### ● Example of order code designation

