

Mini Type Spray Nozzle

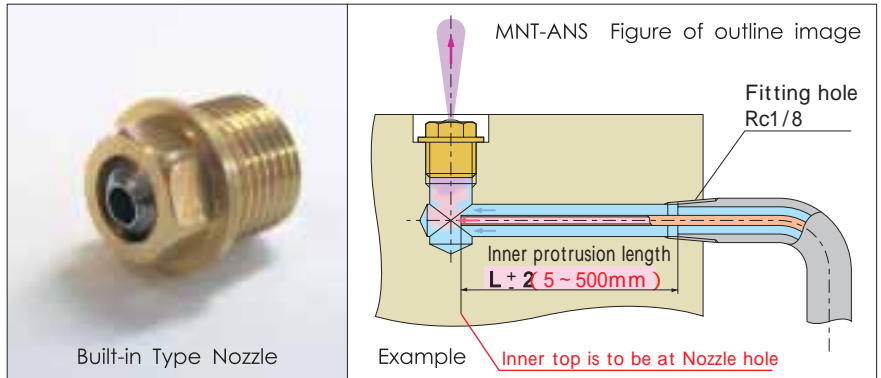

Use

Suitable for small Spray arm. Die built-in type is also available.

Characteristics

Dual-pipe is used for CV-330 and MNT.

Die lubricant and air are mixed in or just before Nozzle, which avoid stagnant fluid in the circuit.

Nozzles

※Nozzle only is not sold.

Type	DK Nozzle			Block Nozzle		Die Built-in Type Nozzle
	DK-6-6	DK-6-7	DK-6-8	ABK-C	ABK-F	MNT
Shape						
Spray (Distance 100mm)	Die lubricant:0.2MPa/Air:0.4MPa			Die lubricant:0.05MPa/Air:0.4MPa		Die lubricant:0.2MPa Air:0.4MPa

Mini Type Spray Nozzle

Specification

Model	Structuring parts			
	Fitting Block	Main body	Connection Pipe	Nozzle
CV-220ANS (Mixing in Main body)				DK-6-6
				DK-6-7
				DK-6-8
CV-330ANS (Mixing in Nozzle)				DK-6-6
				DK-6-7
				DK-6-8
				ABK-C
				ABK-F
MNT-ANS (Die built-in type)			Nozzle	
	MNT connecting hose Designate length on order. HL(100~1,000mm)	MNT Connecting pipe Designate protrusion length		

Example of order code designation

Model	Nozzle	Nozzle distance X/Y(mm)	※Order for X, Y : in 5mm unit
CV-220ANS	DK-6-6	150	
Model	Hose length HL(mm)	Inner tube length L(mm)	※Order for HL : in 50mm unit
MNT-ANS	750	315	

CV-220ANS

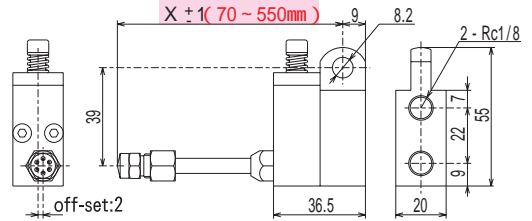

CV-330ANS

