

## Mini Type Spray Nozzle

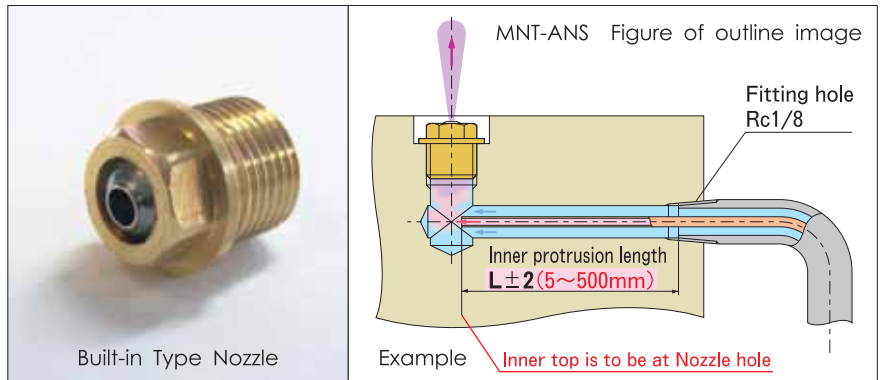

### Use

Suitable for small Spray arm. Die built-in type is also available.

### Characteristics

Dual-pipe is used for CV-330 and MNT.

Die lubricant and air are mixed in or just before Nozzle, which avoid stagnant fluid in the circuit.

### Nozzles

※Nozzle only is not sold.

Type	DK Nozzle			Block Nozzle		Die Built-in Type Nozzle
	DK-6-6	DK-6-7	DK-6-8	ABK-C	ABK-F	MNT
Shape						
Spray (Distance 100mm)	Die lubricant:0.2MPa/Air:0.4MPa			Die lubricant:0.05MPa/Air:0.4MPa		φ 100 Round Die lubricant:0.2MPa Air:0.4MPa

# Mini Type Spray Nozzle

## Specification

Model	Structuring parts			
	Fitting Block	Main body	Connection Pipe	Nozzle
CV-220ANS (Mixing in Main body)				DK-6-6
				DK-6-7
				DK-6-8
CV-330ANS (Mixing in Nozzle)				DK-6-6
				DK-6-7
				DK-6-8
				ABK-C
				ABK-F
MNT-ANS (Die built-in type)			Nozzle	
	MNT connecting hose Designate length on order. HL(100~1,000mm)	MNT Connecting pipe Designate protrusion length		

## Example of order code designation

Model	Nozzle	Nozzle distance X/Y(mm)	※Order for X, Y : in 5mm unit
CV-220ANS	DK-6-6	150	
Model	Hose length HL(mm)	Inner tube length L(mm)	※Order for HL : in 50mm unit
MNT-ANS	750	315	

CV-220ANS

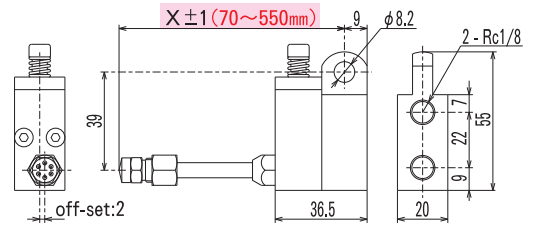

CV-330ANS

